

Laid down at 20 (140) Chain bears down  
Chain of Iron

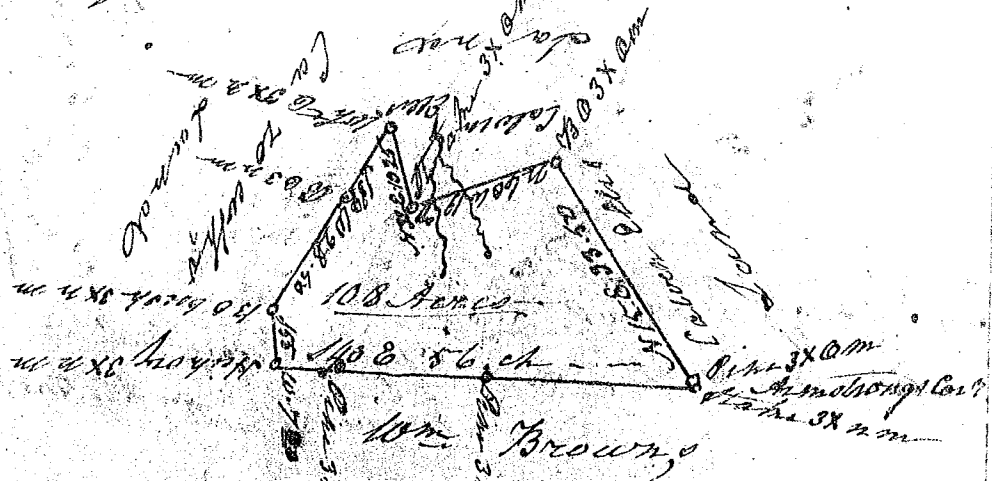

South Carolina Land  
Brunswick District & Pursuant to a warrant

from John Young Esq. Comptroller  
of the State for the District of Brunswick  
On the 8<sup>th</sup> Day of March 1817 I have caused to be  
measured and laid out unto William Brown  
a tract of Land containing 108 Acres on the South  
side of Reddy River or small branch of the same  
Bounded by Cassin's line running N.E. and S.E.  
N.W. by Adam Carouth's line running S.W. and S.E.  
by William Brown's line and has seen forms  
and marks in things and boundaries as the  
above Plat represents - Surveyed and certified  
by me this 8<sup>th</sup> Day of March 1817

B. Griffith Esq.

Recorded the 14<sup>th</sup> Day of April 1817 by

John Young Esq.